

# Education Resource Library

Located in the Main Building on South Campus



# What is in the collection?

## Primarily:

- Children's and Young Adult Books
- Professional Books on Teaching



## Along with some:

- Reference Books and Journals
- Video and Sound Recordings
- K-12 Textbooks
- Montessori Toys
- Books for reading tutors



# What else is here?

## Self service checkout machine

- Located behind the desk across from the main entrance
- Instructions and contact information for help are available next to the machine



#1 Touch Check out



#2 Scan your ID



#3 Scan the item's library barcode

## Public computer

- Log in with your Butler Username and Password
- Please sign out when you are finished

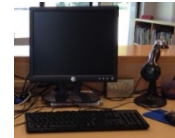

## Book drop

- Please use the book drop for items that you are returning after checking them out
- Library materials can also be returned to the book drop at Irwin Library



Located in the hallway outside the glass door entrance to the library

## Re-shelving cart

- Please place library materials here if you have taken them off the shelves and are not going to check them out



## Study spaces



## Commuter student amenities

- Lockers, refrigerator, sink, etc.



# Access to the library

Through the main entrance  
when the doors are open



OR

COE students, faculty, and  
staff can use their Butler ID  
card to access the library  
through Room 104 when  
the South Campus Main  
building is open



# How is the collection organized?

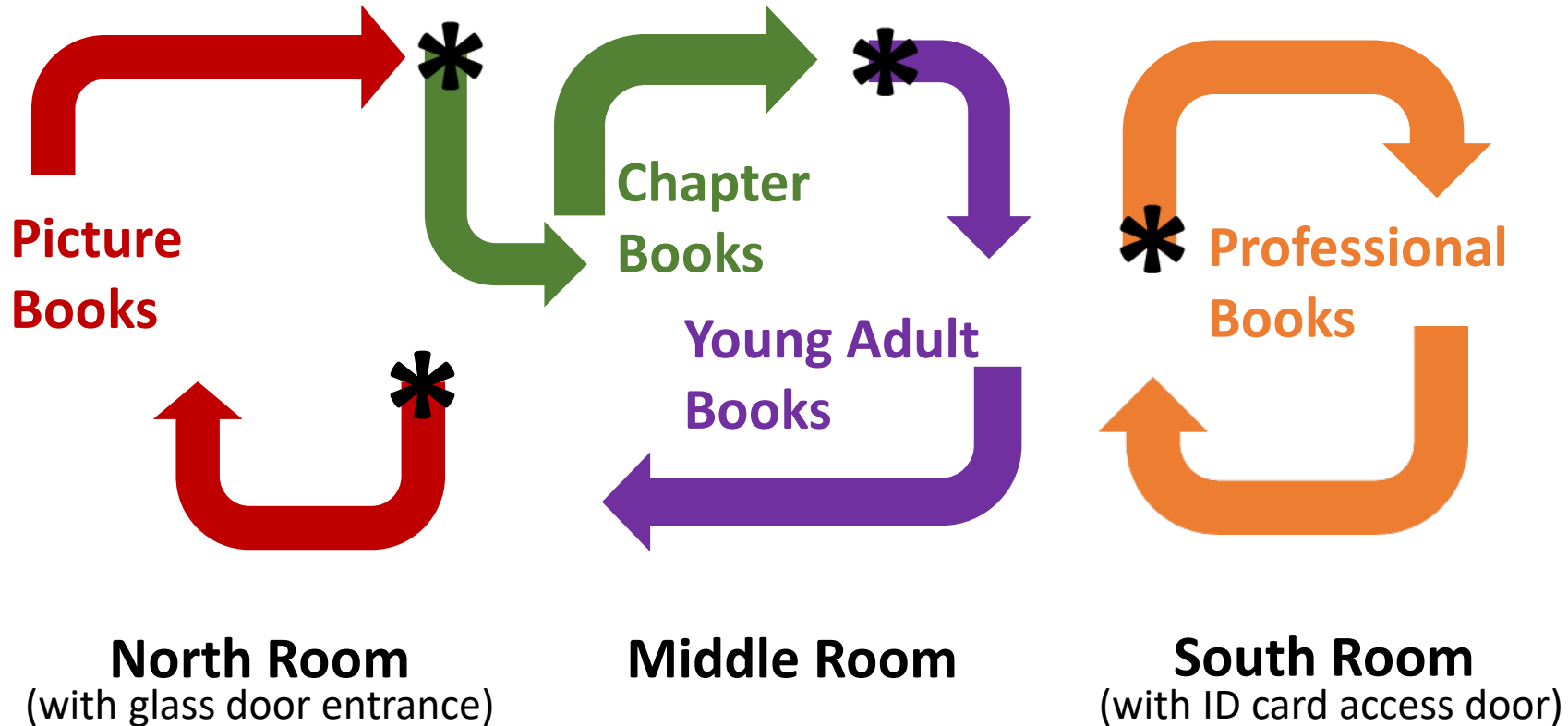

\* Starting point for a segment of the collection

These are the largest parts of the collection. For a more detailed layout, please see the Appendix.



# North Room

**Picture Books**

Start here



... and continue here



... and along the walls



**Biographies**  
(all reading levels)

**Chapter Books**

Start here



... and continue  
around the corner  
into the middle room

# Middle Room

**Chapter Books**

Continue along the wall

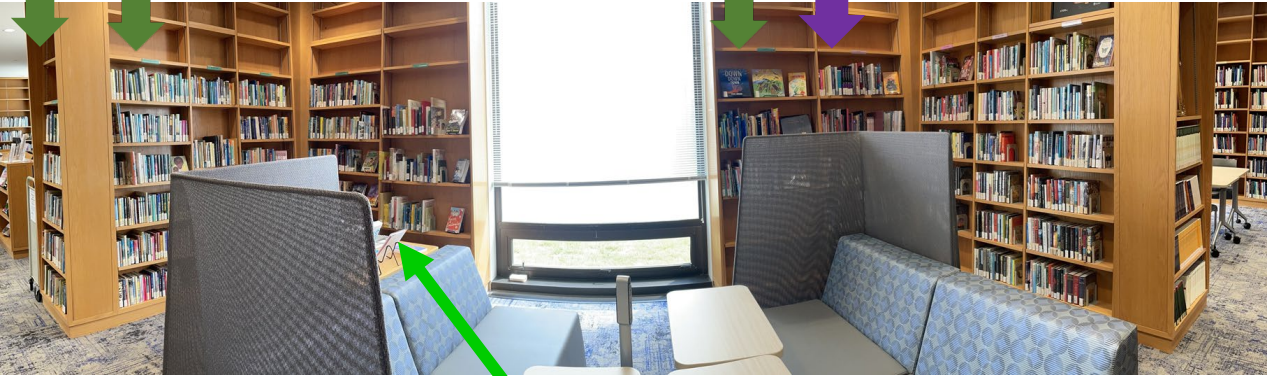

**Young Adult Books**

Start here and continue

... on the other side of the room



**Dr. Ena Shelley  
Collection**  
(on low table)

**A/V Collection**

**Periodicals**  
(lift shelves to  
find older issues)



# South Room

## Professional Books

Start here and continue along the walls



ID Card Access Door



Commuter student lockers and kitchen



Tutoring Collection (on the bottom shelf)



Kits (Montessori Toys) and Textbooks

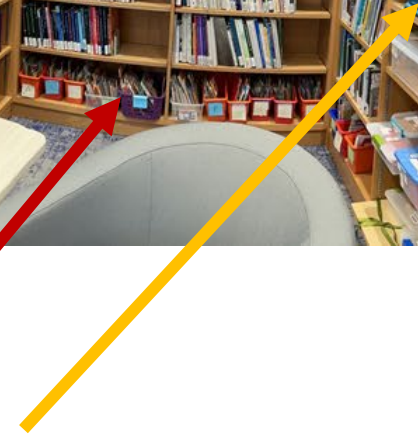



# Materials are organized in Library of Congress call number order

Call numbers start with a one or two letter code based on the topic or genre

(In general: social sciences at the beginning, arts in the middle, and math/physical sciences/technology at the end)

For example, in the bookcase of Biographies, you would find biographies in this order:

Civil Rights Leaders - Athletes - Musicians - Artists - Writers - Mathematicians - Scientists - Inventors



For more information on call numbers, please see the Appendix

# Help with finding books on the shelves

Example of a record from [WorldCat Discovery](#):  
(the online catalog – available on the [library home page](#))

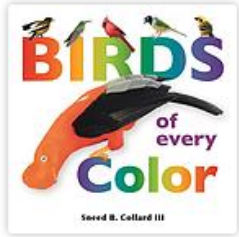

## [Birds of every color](#)

by [Sneed B Collard](#), [Braden Collard](#)

Print Book 2019 | [Explore all editions & formats](#)

A first look at the variety, roles, and sources of colors in birds, featuring photographs by the author and his son.

Held by Butler University Libraries

✓ Available [Map It](#) Education Resource Library Picture Books QL676.2 .C65 2019  
Library Location Call Number

The **Map It** tool can help with the general location

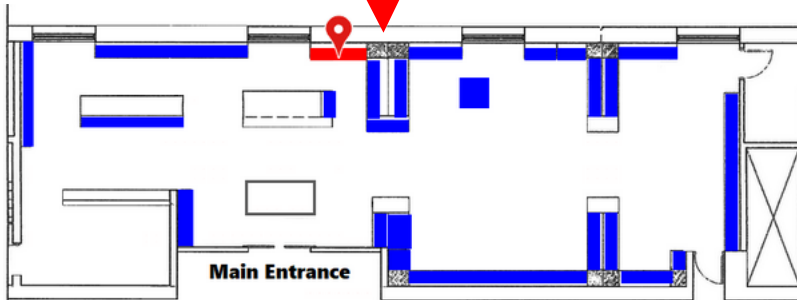

Labels above the shelves show the call number ranges in that section

# Limiting a search to the Education library



After a catalog search, if you are in the Education library and only want to find an item that is in that library, you can limit your WorldCat Discovery search results to the Education Library by selecting it under the **Held By Library** limiter on the left side of the results page

Please keep in mind, though, that there are some children's and young adult books, as well as many professional books, that are in Irwin Library and many more are available online. Using this limiter will remove many of them from your search results.

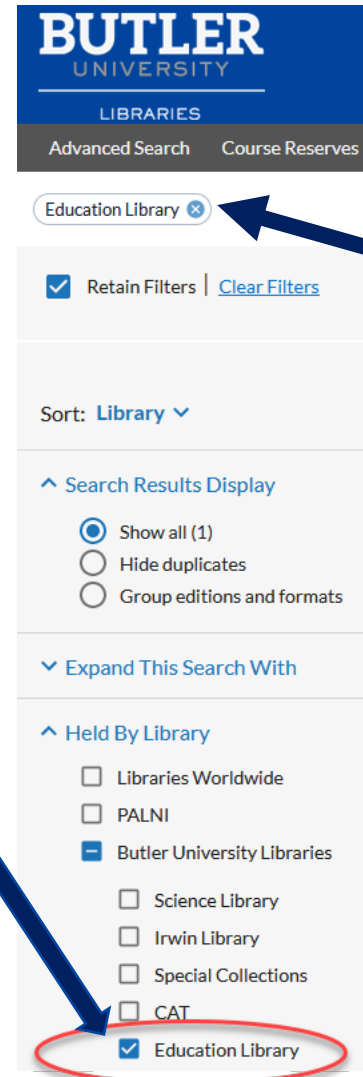

If you want to remove a limiter that you previously selected, you can click on the X for that limiter

# Questions?

## LibGuides

These online guides include useful resources and search tips

Examples:

[Children's and Young Adult Literature](#)

[Curriculum Resources](#)

[Education Research](#)

Please contact me (Janice Gustaferra) if you have questions or need help

I am happy to help! My email address is [jgustafe@butler.edu](mailto:jgustafe@butler.edu)



# Appendix

Information on call numbers

Details on the library layout

Code	Topic
B	Psychology/Religion
C/D/E/F	History
G	Geography/Sports
H	Social Sciences
J	Political Sciences
K	Law
L	Education
M	Music
N	Art
P	Language/Literature
Q	Math/Science
R	Medicine
S	Agriculture
T	Technology
U/V	Military/Naval Science
Z	Books/Information

# Examples of Library of Congress Call Number Codes for Topics/Genres

Code	Topic/Genre
PZ7	Children's and Young Adult Fiction
PZ7.5	Novels in Verse
PZ7.7	Graphic Novels
PZ8	Fairy Tales
PZ8.1	Folklore
PZ8.2	Fables
PZ8.3	Stories in Rhyme

Some examples within the Ls, which cover Education:

- LA History of education
- LB Theory and practice of education
  - LB51-885 Philosophies of individual educators
  - LB1027.5 Student guidance and counseling
  - LB1027.9 School Choice
  - LB1028.24 Teacher research
  - LB1049.9-1050.75 Reading
  - LB1057-1060 Psychology of learning
  - LB1101-1139 Child study
  - LB1555-1602 Elementary education
  - LB1603-1696.6 Secondary education
  - LB2801-3095 School administration
- LC Special Aspects of Education
  - LC89 Social aspects (in the US)
  - LC196 Critical pedagogy
  - LC212-212.863 Discrimination in education
  - LC215-238.4 Community and the school
  - LC1099-1099.5 Multicultural education
  - LC3731-3740.4 Bilingual education
  - LC3950-4806.5 Special education
  - LC5101-5143 Urban education

For more information, see the [Library of Congress Classification Outline](#)

# Brief explanation of the call numbers

## *In general:*

letter code & numbers\* . letter & numbers Date published

topic or genre

(similar topics/genres grouped together)

\*numbers may include decimal points

author

(alphabetical order by author's last name)

## *Example:*

QL676.2 . C65 2019 for *Birds of Every Color* by Sneed B. Collard

Children's books on birds



# Some Exceptions

## ***Children's and Young Adult fiction:***

letter code & numbers . letter & numbers letters Date published  
alphabetical order by title

PZ7 . **C**21476 **V**e 1987 for *The **V**ery Hungry Caterpillar* by Eric **C**arle

Children's fiction

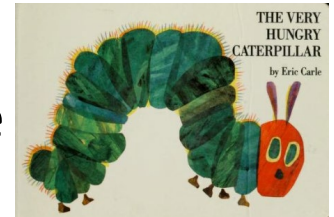

## ***Biographies:***

letter code & numbers . letter & numbers letter and numbers Date  
person in biography author of book

QA29 . **J**64 **B**43 2018 for *Counting on Katherine\** by Helaine **B**ecker

Biography of a mathematician

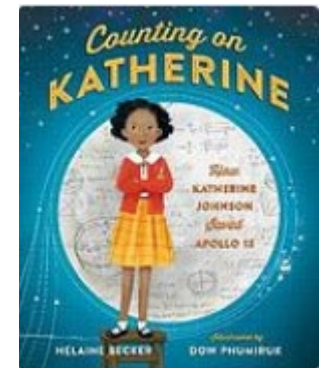

\* A biography about Katherine **J**ohnson



# More details on the library layout

