

RESIDENTIAL COLLEGE DOUBLE ROOM WITH ADJACENT LOUNGE

Green = Dresser That dresser is
Dimensions are 34" W x 64" H x 21" D with 5 drawers

Orange = Main door opening

Blue = Bathroom door opening

Red = Window Wall

Dimensions are 46" W x 64" H x 5" D; 33 1/2" from floor
Curtain provided for window in most spaces

Dotted line = wardrobe

External dimensions are 72" H x 24 1/2" D x 38" W

Internal dimensions are 65" H x 22" D x 36 1/2" W

Grey = beds

Twin XL mattress

Bed frame dimensions at 40" W x 33" H x 86" L

Bunkable with pins provided, Lofting not permitted

14 FEET, 7 INCHES

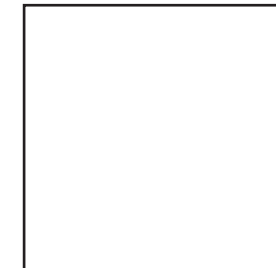

14
FEET
7
INCHES

Since this room was originally a single unit, an adjacent lounge is provided for the four residents in the suite. This lounge contains the desks that would have originally been in the room. See dimensions above.

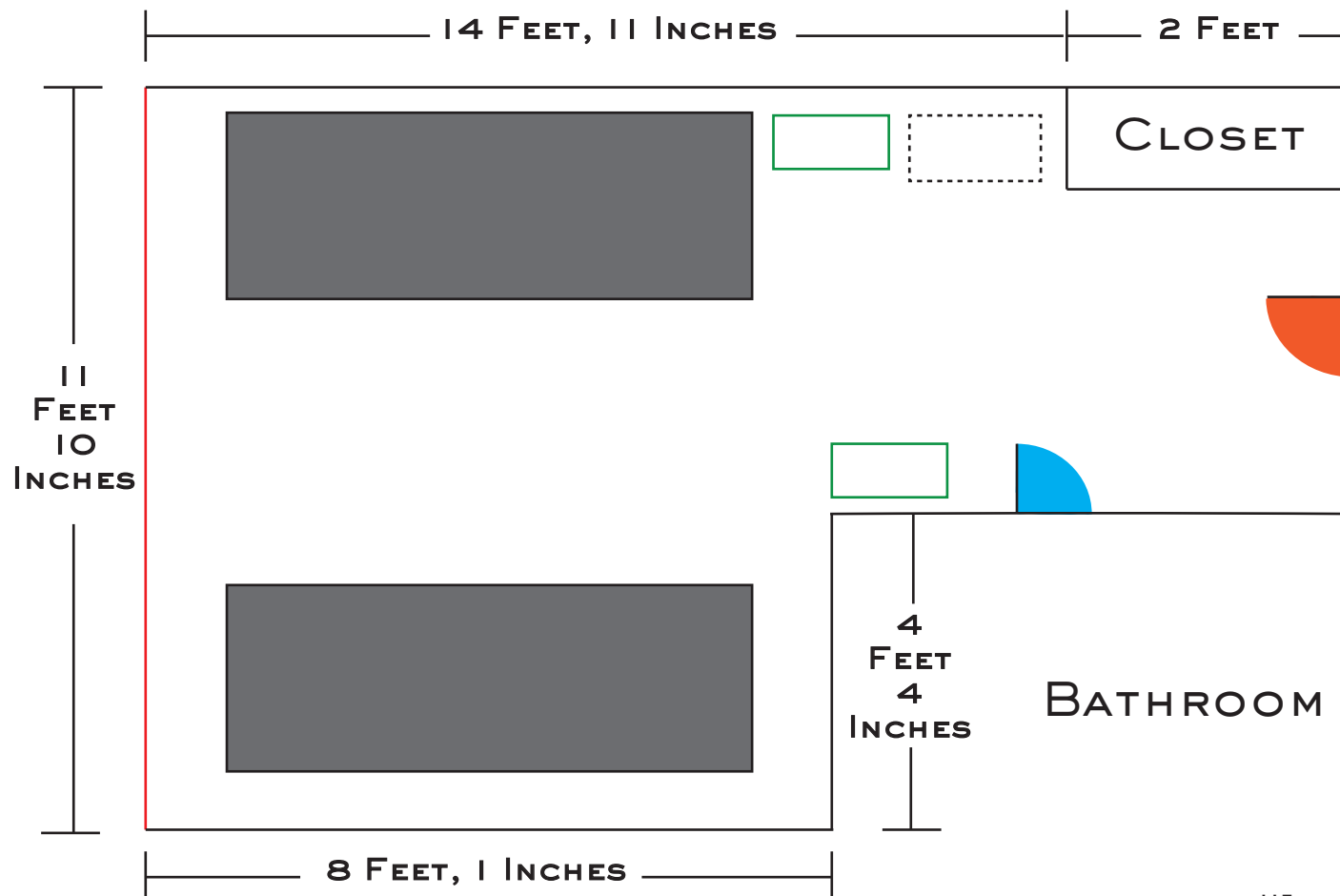

Figure Not Drawn to Scale